

# LIGHT BLOCKING ACCESSORIES

**SIDE CHANNEL**

**CENTER CHANNEL**

A little bit of light peeking through the edge of a shade can be like a spotlight in a dark room, especially if you are sleeping! By adding any of our Light Blocking Accessories, which can be used with any of our shading systems, you can rest easy by combating those nasty, little light leaks. These accessories can be used in combination with any of our Shade Pockets, Bottom Closures or Fascia options to create a more complete light blocking or blackout solution.

## Side Channel

**Side Channel** can be installed along the sides of a shade to prevent light from entering through past the edges the fabric. **Side Channel** wraps the edge of the fabric and Hembar so they can freely ride inside while the shade is in motion.

**Center Channels** can be installed between two shades (or shade bands) to eliminate the gap between them and still allow them to operate independently.

**Side Channels** and **Center Channels** come in five colors each, allowing you to choose the perfect look for your space.

When ordered with a shading system, **Side Channels** and **Center Channels** will include our original **Channel Caps** that protect your finishes from the sharp edges at the top and bottom of the channels. These **Channel Caps**, which you can only find at WT Shade®, are color coordinated based on the selected aluminum finish color.

All Light Blocking Accessories are compatible with our Sealed Hembar or External Hembar, and can be added at installation or any time in the future!

**SILL CHANNEL**

**Sill Channel** is the optimal way of eliminating those frustrating light gaps at the bottom of your shades. All **Side Channels** and **Center Channels** fit neatly in our **Sill Channels**, giving you the perfect corner every time!

# LIGHT BLOCKING ACCESSORIES

Content:  
Aluminum Alloy

## SIDE CHANNEL

### AVAILABLE COLORS:



- ◆ Standard Available Length: 18' (216")
- ◆ Can be precut to specified sizes or shipped in full length pieces.
- ◆ Can be Face Mounted using hole plugs (SCHP-XX\*).
- ◆ Channel Cap is available in White (-10) and Black (-90) and will be color coordinated to the selected aluminum color when ordered with a shading system (SCHTC25-XX\*)\*\*

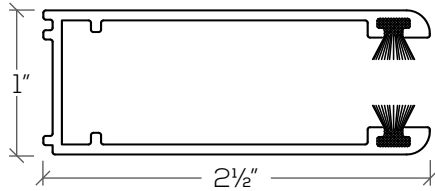

**Part # SCH25-XX\***  
2 1/2" Side Channel

### COMPATIBLE WITH:

Sealed Hembar (SSP-99)  
External Hembar (HBX-XX\*)

Content:  
Aluminum Alloy

## CENTER CHANNEL

### AVAILABLE COLORS:



- ◆ Standard Available Length: 18' (216")
- ◆ Can be precut to specified sizes or shipped in full length pieces.
- ◆ Can be Face Mounted using hole plugs (SCHP-XX\*).
- ◆ Channel Cap is available in white and black and will be color coordinated to the selected aluminum color when ordered with a shading system (SCHTC25-XX\*)\*\*
- ◆ For Multibanded Shades and applications where two shades meet bracket to bracket.

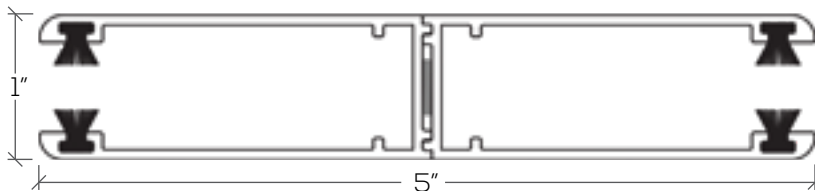

**Part # SCHC5-XX**  
5" Center Channel

### COMPATIBLE WITH:

Sealed Hembar (SSP-99)  
External Hembar (HBX-XX\*)

## AVAILABLE COLORS:



## SILL CHANNEL

Content:  
Aluminum Alloy

- ◆ Standard Available Length: 18' (216")
- ◆ Can be precut to specified sizes or shipped in full length pieces.
- ◆ Compatible with all Side or Center Channels.

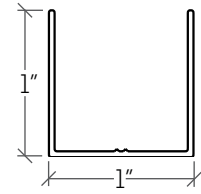

**Part # SCH10-XX\***  
1" Sill Channel

## COMPATIBLE WITH:

Sealed Hembar (SSP-99)  
External Hembar (HBX-XX\*)

## AVAILABLE COLORS:



## LIGHT STOP ANGLE

Content:  
Aluminum Alloy

- ◆ Standard Available Length: 18' (216")
- ◆ Can be precut to specified sizes or shipped in full length pieces.

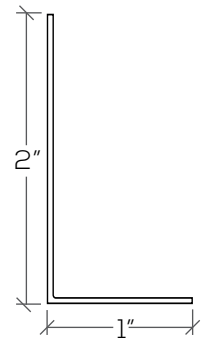

**Part # LS12-XX\***  
1" x 2" Light Stop Angle

## COMPATIBLE WITH:

Sealed Hembar (SSP-99)  
External Hembar (HBX-XX\*)  
Round External Hembar (HBXR-XX\*)  
Round Internal Hembar (HBNR-20)  
Heavy Duty External Hembar (HBXHD-10)  
Duplex Hembar (HBD-99)

## SIDE & CENTER CHANNEL ACCESSORIES

### CHANNEL CAPS

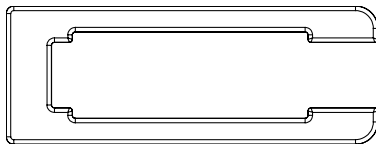

**Part #SCHTC25-XX\***  
Channel Cap for 2½" Side  
& 5" Center Channels

### CHANNEL CAP COLOR COORDINATION CHART

If Aluminum color is:	Channel Cap color will be:
White (-10)	White (-10)
Ivory (-04)	White (-10)
Silver (-20)	White (-10)
Bronze (-50)	<b>Black (-90)</b>
Black (-90)	<b>Black (-90)</b>

### HOLE PLUG

#### AVAILABLE COLORS:

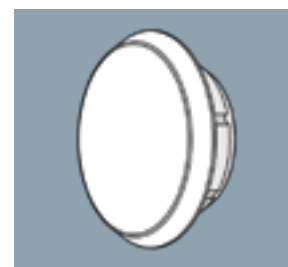

**Part #SCHP-XX\***  
½" Hole Plug  
for Face Mount Applications